

IN CONVERSATION

Daniel Libeskind

ARCHITECTURE

House at Panchgani: Practice Architecture
Khamir Crafts Resource Centre, Kutch: Prof. Neelkanth Chhaya
The Book Building, Chennai: moad
Residence in Ahmedabad: SAK Designs

INTERNATIONAL

Sunset Chapel in Acapulco: BNKR Arquitectura

YOUNG DESIGNERS '13

Swarnabhoomi Academy of Music: Studio 7 Consultants Pvt. Ltd.

BOOK REVIEW

Architecture of Shivdatt Sharma: Vikramaditya Prakash

SPACE FRAMES

Traces of Struggle: Surendra Lawoti

A&B





WildEcho

WildEcho, designed by Mahesh Naik of Farmhouse Organic Architecture, is built using local organic materials as an expression of the rustic environment of Agarsure, Alibaug.

Images & Drawings: courtesy Azim S Wadkar, Mahesh Naik

Considering imitation to be the highest form of flattery, the WildEcho in Agarsure, Alibaug designed by Mahesh Naik of Farmhouse Organic Architecture, draws heavily from nature and its organic shapes. The design of area 14430sqft, is based on an organic grid of triangular and circular geometry. It is an assemblage of four nuclear dwelling units situated around a cluster of existing Palmyra Palms establishing a relation between the built fabric and the topography of the site. The palms manifest as the focal point in the design, which bears a resemblance to the jagged silhouette of the structure.

At first, the WildEcho appears inconspicuously shrouded amidst the thick foliage of trees. Facing inward, the dwelling units act as a screen from the harsh sunlight and rain of the south-west, protecting the more intimate spaces such as the deck area around the pool.

Each of the dwelling units comprises of a living space and kitchen on the lower floor. A staircase leads up to the toilet at the mezzanine level and the bedroom on the upper floor. Local materials are being used in the load-bearing construction of the WildEcho. Black basalt stone is used in the foundation for the structure. The 14" thick brick walls have better insulation, keeping the harsh sunlight at bay. Implemented in the

construction of arches in the design, the difference in layering of bricks creates an interest in the façade. The use of Mangalore tiles proves to be a more eco-friendly option to cement. Sharply defined balconies and roofs that are seemingly precarious, project out into the pool, resting on a protruding vertical support. The daring cantilever of the roof that defines the entire structure is made possible by the use of hollow steel M.S box sections. ■



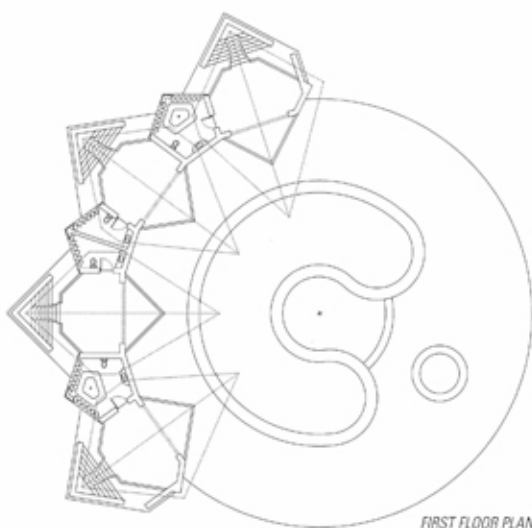
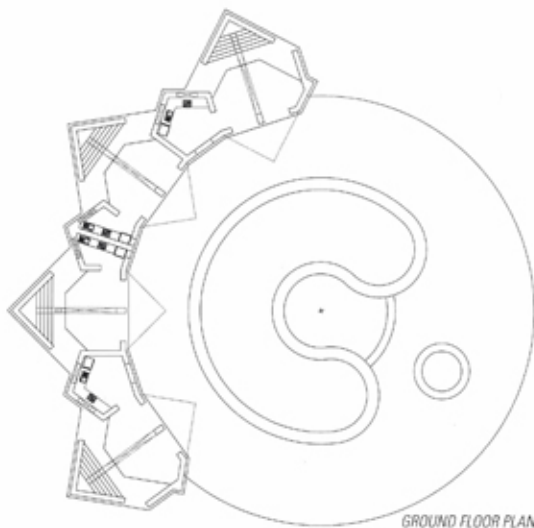
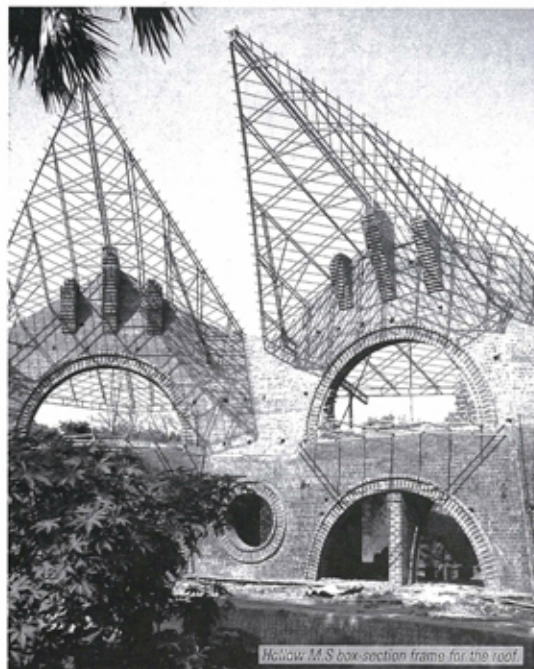

FACT FILE:

Project Name	:	WildEcho
Location	:	Agarsure, Ailbaug, Maharashtra
Architect	:	Mahesh Naik
Client	:	Mr Nikil Kapoor, Soojata Kapoor
	:	Mr Sanjay Kapoor
Area of Ground Floor	:	2980sqft (Plinth Area)
Area of First Floor	:	3270sqft
Area of Deck and Pool	:	8180sqft (Plinth Area)
Total Construction Area	:	14430sqft